



Application Software
CETA Soft 2G for free!



Leak Tester CETATEST 815 - makes precision work

The CETATEST 815 is a fully automatic working leak tester for the detection of untight parts within the cycle time of the production process. The pressure in the test part volume due to a leakage is compared with the pressure in a tight reference volume (differential pressure method).

Operating methods

One channel operation

Signal processing

Fast 24-bit-A/D-Converter
Real-time processing of the measurement signals

Valve types

Depending on the application:
sliding valve or poppet valve

Processing

Real time microcontroller system,
16-bit μ C / 40 MHz

Pressure sensors

Differential pressure sensor
gauge pressure sensor

Measurement ranges

± 500 Pa / $\pm 5,000$ Pa
(displayed resolution: 1 Pa,
internal resolution: effective 0.01 Pa),
other ranges on request

Result units

Pa, hPa, PSI, Pa/s, hPa/s, mbar* l/s ,
ml/min, ml/h, l/min, l/h, mmHg, mmWs, Torr

Pressure ranges

-1 bar, +/-5 mbar, +/-50 mbar, 200 mbar,
1 bar, 6 bar, 10 bar, 20 bar, 30 bar,
negative gauge pressure and positive
gauge pressure ranges can be combined,
(e.g. -1 bar / +1 bar), other pressure ranges
and mechanical pressure regulator on
request

Maximum Deviations

Gauge pressure: 1 % *
Specification for combined devices based
on positive gauge pressure
Differential pressure: 0.5 %
referred to measuring range

Test modes

Pressure decay
Optional: sealed component, dynamic
pressure, pressure steps, pressure rise
(with double leak connector)

Test options

Prefill (multiple filling), program
series, smooth filling, repeated filling,
temperature compensation, variable zero
point, test repetition / automatic test time
adjustment, free programmable control
valves

System control

Still-Alive-Check with differential pressure
sensor control, automatic function control
(option), control of the compressed air
supply, consecutive zero results

Programmable test phases

Delay, prefilling, preventing, filling,
stabilising, measuring, venting, reservoir
filling, flood, refilling

Test mode specific limits

Prefill pressure, filling pressure, test part
specific reject and rework levels

Handling

Intuitive menu including password
protected user levels

Parameter memory

64 individually parameterizable test
programs with alpha-numeric program
names, parameters of the test programs
can be exported resp. imported via the
test device interfaces or by usage of a USB
storage device.

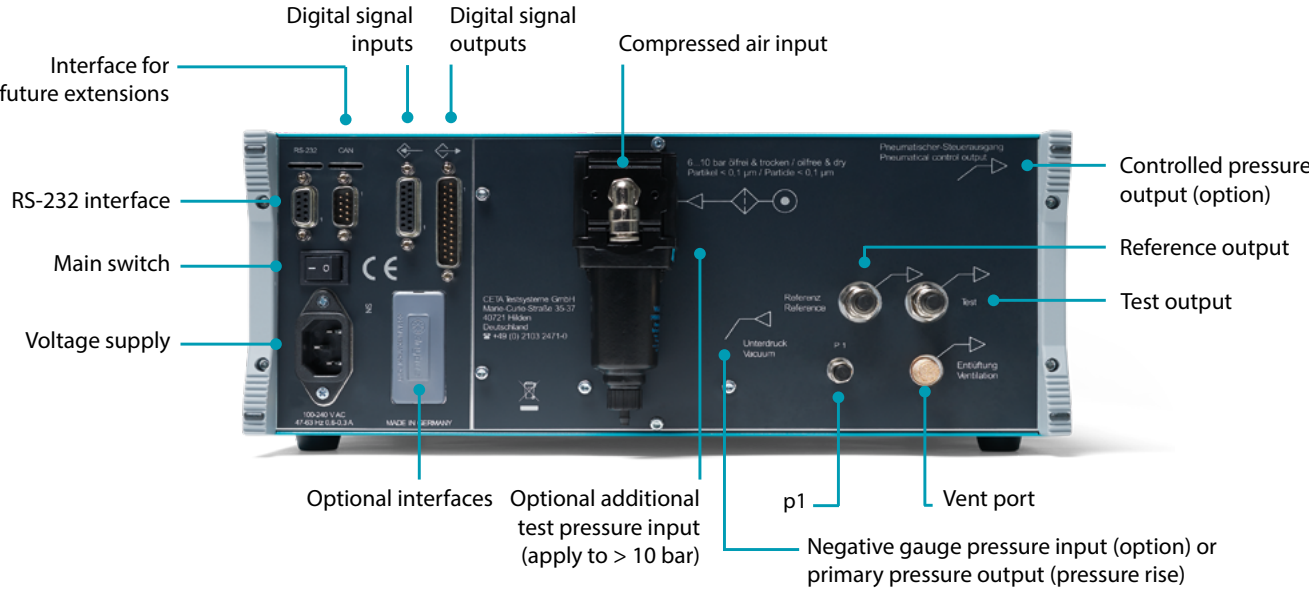

Interfaces		Start / Stop / Reset	Program selection	Device status / system error	Evaluation (Pass / Fail)	Parameterization	Measurement results	Measurement curve	Phase information in real time	Error messages
Standard	Digitale I/O	■	■	■	■					
	RS-232	■	■	■	■	■	■	■	■	■
	USB Host (Front)				■	■	■	■		
Option (one selectable)	Profibus DP	■	■	■	■	■	■	■	■	■
	Profinet	■	■	■	■	■	■	■	■	■
	Ethernet	■	■	■	■	■	■	■	■	■
	EtherCAT	■	■	■	■	■	■	■	■	■

Further interfaces (e.g. Bluetooth, WiFi & USB Slave) on request. The optional RS-232 protocol converter enables the exchange of a CETATEST 810 that communicates via RS-232, against a CETATEST 815.

Further functions

Result statistics, indicator for service intervals, registration of parameter change, recording of measurement series and measurement curves, Dynamic Link Library (DLL) for RS-232 interface programming

Power supply / Power consumption

100 - 240 VAC / 47 – 63 Hz / 0.6 - 0.3 A depending on stage of expansion max. 60 W

Compressed air supply

6 - 10 bar and 0.5 bar above test pressure resp. 50 mbar under evacuation pressure (ISO 8573-1:2010 [1:4:1]). Test devices with pressure ranges higher than 10 bar have an additional connection for the external compressed air >10 bar.

Pneumatic connections

Input (compressed air supply): 6 mm plug-in fitting
Port for test part: 6 x 1 mm fitting, 6 mm clamping ring (option), up to three pneumatically driven outputs (option)

Dimensions and weight

W x H x D:
345 mm x 145 mm (3 U) x 435 mm
Weight: approx. 10 kg

Scope of delivery

Special packaging, power cord, documentation and PC-software on CD, DAKKS calibration certificate, EU declaration of conformity, D-Sub-plug including cable for inputs and outputs (PLC-communication), spare sealing caps and spare caps for union nuts coupling or spare clamp rings

DAKKS calibration and DAKKS calibration certificate

All new CETATEST 815 devices will be delivered free of charge with DAKKS calibration certificate according to DIN EN ISO/IEC 17025.

Warranty

3 years in case of yearly maintenance, optional prolongation to 5 years

Accessories (optional)

Filter combination, standard leak, leaktight 3/2-way valve, RS-232 / Ethernet adapter, application software CETA Soft 2G, scanner interface, more in the CETA accessories catalogue.